

QUICKSTART "BASIC" GUIDELINES FOR MODEL 6500 - FOR GATES UP TO 12 FEET AND OPENING 90°

Model 6500 is intended for installation only on swing gates used for vehicles.

Pedestrians must be supplied with a separate access opening.

For safety and installation instructions, please refer to the Installation/Owner's manual.

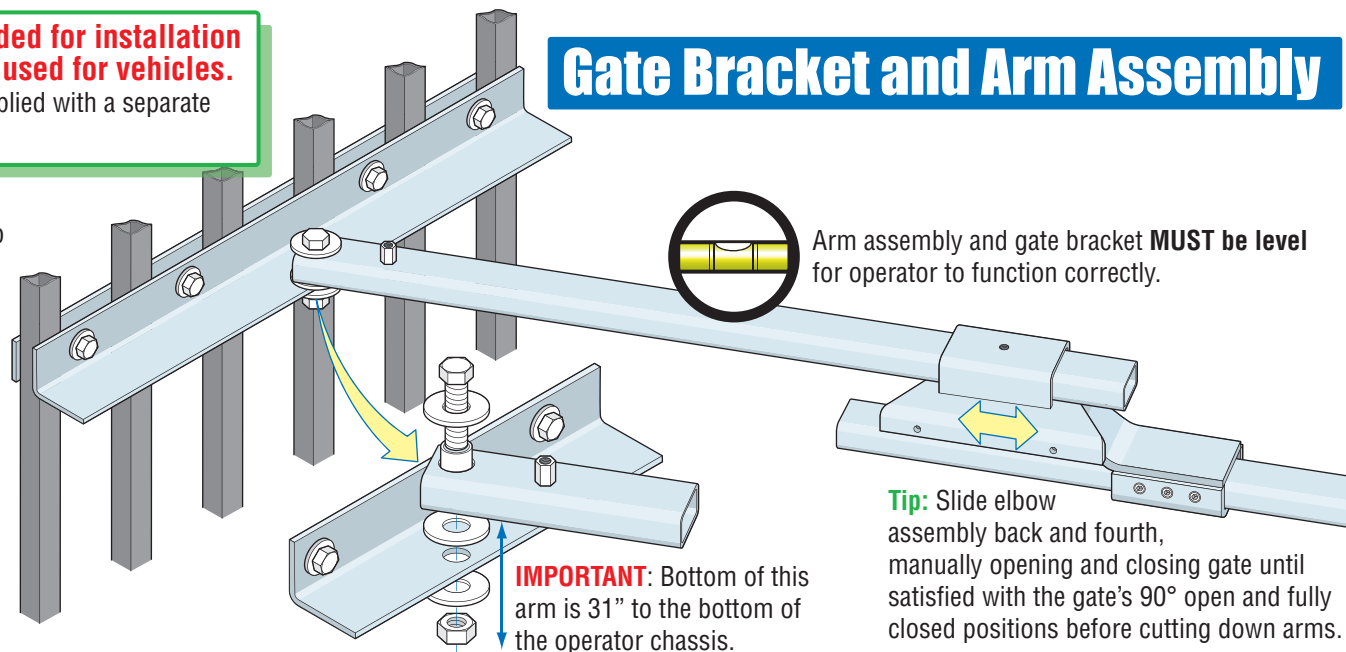

Limit Sensors

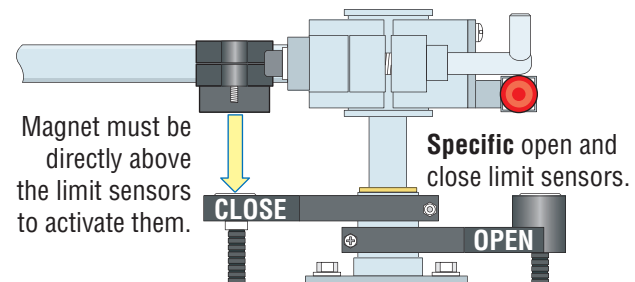

Manual Release Tool

CAUTION
NEVER REMOVE HUB after manual release

DKS
DOOR KING®

120 Glasgow Avenue
Inglewood, California 90301
U.S.A.

AC Power Connection

OPERATOR MUST BE PROPERLY GROUNDED!!

Tip: It is recommended that a surge suppressor be installed on the high voltage power lines.

DANGER
HIGH VOLTAGE!

115 VAC

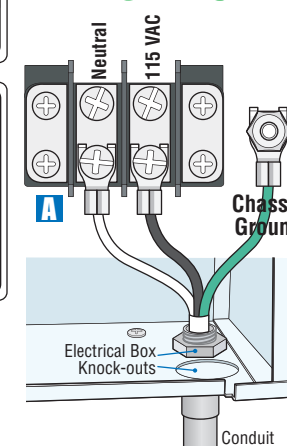

CAUTION
Limit sensors **MUST** be in position **BEFORE** cycling operator the first time.

PUSH TO OPERATE
Technical Use Only

DIP-Switches

SW 1

1. Changes Gate Opening Direction (See reverse side)
2. OFF
3. OFF
4. **ON** → Auto Close Timer
5. OFF
6. OFF
7. OFF
8. OFF

SW 2

1. OFF
2. OFF
3. OFF
4. OFF

Adjust 1 to 23 sec.

Note: "Optional" High Voltage Kit black and white wires connect the same as shown. See High Voltage Kit instruction sheet for more information.

Loop Detectors

B Not included - Refer to the Installation/Owner's manual and Loop Information Manual (available **FREE** from www.doorking.com) for more information on loops and loop detectors.

Radio Receiver

C Not included - Refer to a specific Radio Receiver Manual (available from www.doorking.com) for more information on radio receivers and antenna installation. (See reverse side for wiring)

Size and Location of Concrete Pad, Operator and Underground Conduit

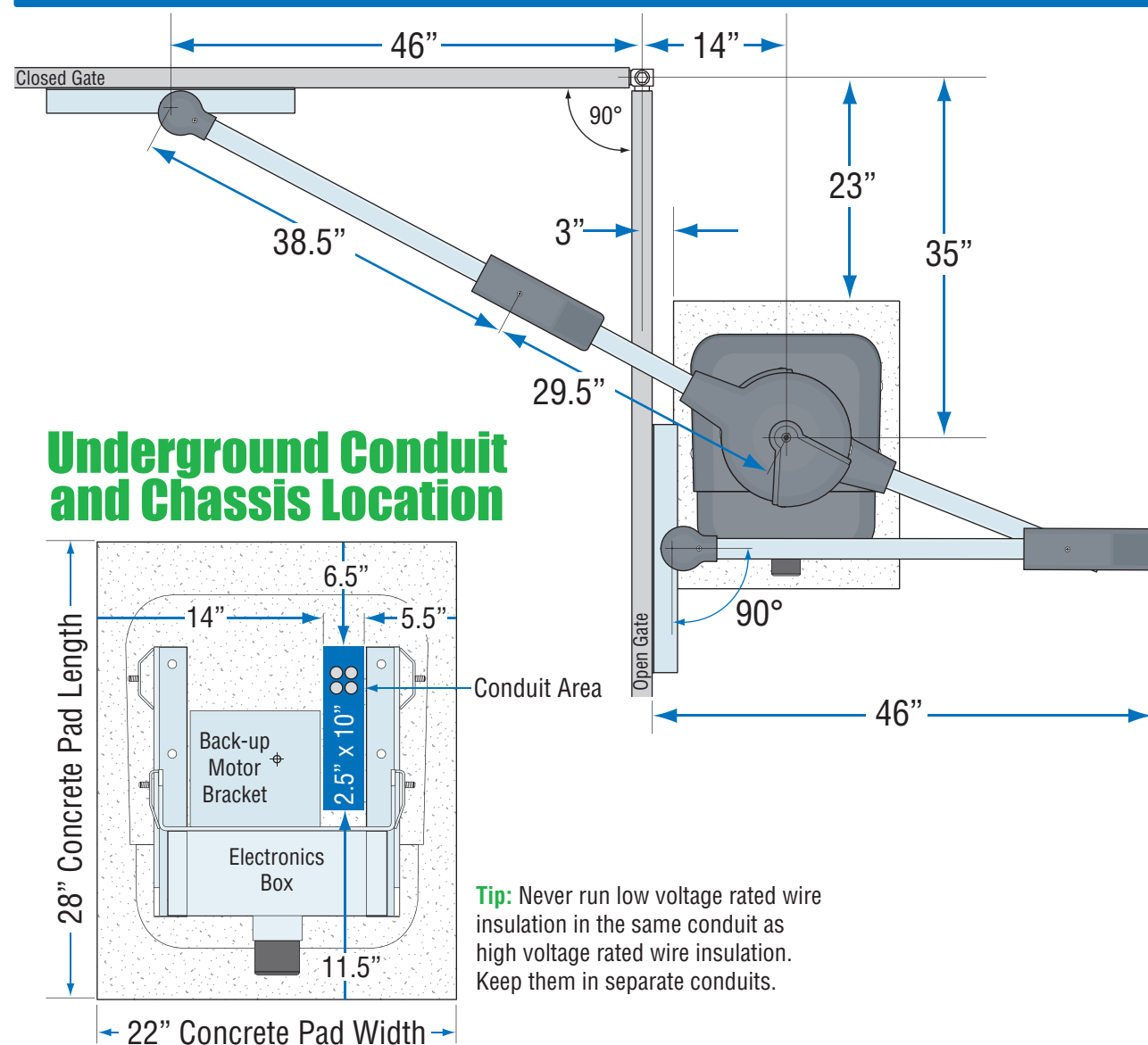

Concrete Pad

Concrete pad **MUST** be level.

Tip: Bevel the edges of concrete pad to eliminate water puddling under the operator.

Concrete Depth

4" minimum above ground.

This depth of the concrete pad is determined by soil conditions and local building codes (reinforced concrete recommended).

Tip: Allow concrete to cure **completely** before attaching operator to pad (48 hours).

QUICKSTART "BASIC" GUIDELINES FOR MODEL 6500 - DIP-SWITCH AND WIRING REFERENCE

Model 6500 is intended for installation only on swing gates used for vehicles. Pedestrians must be supplied with a separate access opening.

For safety and installation instructions, please refer to the Installation/Owner's manual.

SW 1 DIP-Switches



SW 1 (Top 8 Switches)			
Switch	Function	Setting	Description
1	Primary 6500 Changes Gate Opening Direction	 Opens Clockwise	 Opens Counter-Clockwise
		ON	
2	Secondary 6500 Changes Gate Opening Direction	Same as above, for secondary 6500 ONLY .	
3	Exit Loop Port Output	OFF	The output wired to terminal #4 becomes the output from the exit loop detector plugged into the EXIT Loop port.
	Full Open Input	ON	Normal Setting. Terminal #4 is a normal full open input.
4	Auto-Close Timer	OFF	Auto-close timer is OFF. Manual input required to close gate.
		ON	Normal Setting. Auto-close timer is ON. Adjustable from 1-23 seconds.
5	Reverses Gate	OFF	Normal Setting. Input to terminal #6 and reverse loop will stop and reverse gate to the full open position during the close cycle ONLY .
	External Shadow Loop Detector	ON	Input to terminal #6 becomes a SHADOW loop input. It is only active when the gate is fully opened. (Shadow loop setting when external loop detector is used)
6	Single Operator	OFF	Normal Setting. Switch must be OFF for single operator.
	Dual Operators	ON	Switch must be ON when primary/secondary (dual) gates are used.
7 and 8	Circuit Board Relay	7-OFF 8-OFF	Normal Setting. Relay activates when gate is at open limit. (Shadow loop setting when DoorKing Plug-In loop detector is used)
		7-OFF 8-ON	Relay activates when gate is not closed.
		7-ON 8-OFF	Relay activates when gate is opening and open.
		7-ON 8-ON	Relay activates during opening and closing cycle.

SW 2 DIP-Switches



Switch	Function	Setting	Description
1	Gate Overlap	OFF	Primary and secondary operators start at the same time (Normal setting for single gate operator).
		ON	The secondary operator will start 1.5 sec. before primary operator during open cycle and the primary operator will start 1.5 sec. before the secondary operator during the close cycle (Normal setting for bi-parting gate operators).
2	Magnetic lock	OFF	Normal Setting. Magnetic lock is not used.
		ON	Magnetic lock is used and connected to main terminal #9 and #12.
3		OFF	Normal Setting. Switch 3 MUST be turned OFF for Model 6500 operator.
4		OFF	Normal Setting. Switch 4 MUST be turned OFF for Model 6500 operator.

Note: After a DIP-switch setting is changed, power must be turned OFF and then turned back on for the new setting to take affect.

Important: Controls must be installed a minimum of 10-feet from the gate or installed in such a way that the person using the control cannot come in contact with the gate or gate operator.

