



SL Series

COMMON FEATURES

- Granite, black, or tan polyethylene covers
- #41 drive chain
- Pad mount standard; post mount optional
- Exterior reset button
- UL325/UL991 compliant 24 VDC control board
- Manual disconnect

SLC COMMERCIAL

- 1/2 or 1 HP continuous-duty PSC motor
- 115 VAC or 230 VAC single phase

SLD COMMERCIAL/RESIDENTIAL

- DC-powered battery back-up with seamless transition
- Full-time 1/2 HP DC motor
- Selectable fail-safe or fail-secure modes of operation
- Solar power capable

SLR RESIDENTIAL

- 1/2 HP PSC motor
- 115 VAC or 230 VAC single phase

SLIDE GATE OPERATORS

SLC



SLD



SLR



All Models ETL Listed;
UL325 Compliant



Supporters and Proud Members of



ELECTRICAL

- Integral entrapment sensing system with dual multi-turn precision potentiometers for accurate adjustment and enhanced safety
- Continuous-tone entrapment alarm with reset button
- Integrated warning beeper during gate movement
- 15 diagnostic LEDs on board for ease of setup and troubleshooting
- Selectable pre-start alarm with provision for ADA compliant visual pre-start and run alarm
- AC and DC power available for access control accessories
- Integrated maximum run and auto close timer (0-124 secs)
- Built-in master/slave capability using 3-wire shielded cable

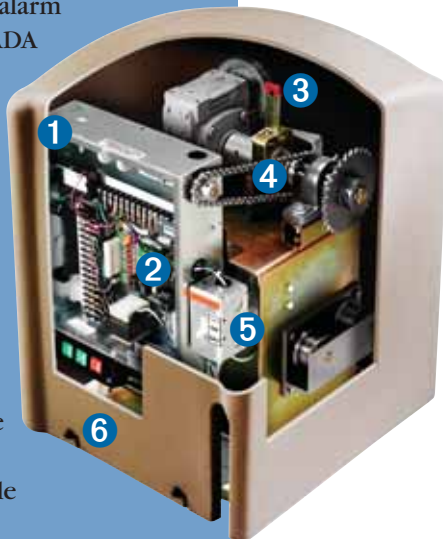

MECHANICAL

- Heavy-duty, zinc-plated, steel chassis
- Easy-to-operate emergency manual disconnect handle
- #41 drive chain — 31' included with operator
- Universal pad mount standard; optional post mount kit

CAUTIONS



- Automatic gates not for pedestrians
- Automatic gate operators designed for vehicular traffic only; operators are powerful and can cause serious injury or death; **DIRECT ALL PEDESTRIAN TRAFFIC TO SEPARATE PEDESTRIAN GATE**
- UL325 requires use of contact or non-contact anti-entrapment devices
- ASTM F2200 requires that all exposed rollers are covered

SL SERIES SLIDE GATE OPERATOR SPECIFICATIONS

Model		HP	Voltage (Single Phase)	Drive Type	Maximum Gate Length	Maximum Gate Weight	Gate Speed	Maximum Cycles
SLC	SLC-2	1/2	115 or 230 V	#41 chain	37'	1000 lbs	11"/sec	continuous duty
	SLC-1	1	115 or 230 V	#41 chain	45'	2000 lbs	11"/sec	continuous duty
SLD	SLD-211	1/2	24 VDC solar optional	#41 chain	25'	700 lbs	8"/sec	30/hour
SLR	SLR-211	1/2	115 V	#41 chain	25'	500 lbs	11"/sec	150/day
	SLR-221	1/2	230 V	#41 chain	25'	500 lbs	11"/sec	150/day

1 Rotary Mechanical Limits

Easy access inside control box

2 Solid-State Control Circuitry

- UL325/UL991 compliant 24 VDC control board
- Full featured for access control, security, and entrapment protection

3 Manual Disconnect

- Secure, easy, manual operation during power failure or emergency
- Optional remote cable kit for outside-the-gate access

4 Heavy-Duty Components

Gear reducer and pillow block bearing for smooth, reliable, quiet power transmission

5 Standard Convenience Features

- Exterior reset button
- Power on/off button
- Accessory power outlet on 115 V machines
- 3-button station

6 Polyethylene Cover

Sleek, sturdy, lockable cover in three UV-stabilized colors (granite, black, or tan)

Dimensions

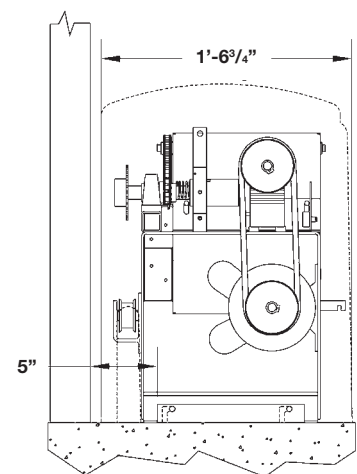
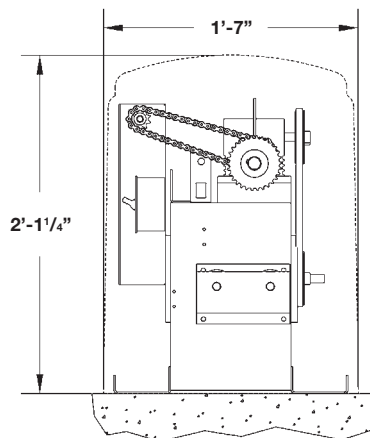

Linear  **OSCO**
OPERATORS

LINEAR

(800) 421-1587 • www.linearcorp.com

OSCO, a subsidiary of Linear

(800) 333-1717 • www.operatorspecialty.com